

# CHARMILL

## RESIDENTIAL



### Blenheim Terrace, St John's Wood NW8

**£808**

A newly refurbished two-bedroom apartment arranged on the second and third floors of a period conversion on Blenheim Terrace. The apartment comprises a spacious open plan kitchen/reception room, two double bedrooms (with fitted wardrobes) and two shower rooms. The apartment benefits from wooden flooring throughout. This property is located on Blenheim Terrace which is just 0.5 miles from St John's Wood Underground station (Jubilee line) and 0.6 miles from Maida Vale Underground station (Bakerloo line). St John's Wood is a well established residential area with a wonderful array of shops, restaurants and transport facilities providing easy access to central London as well as Regents Park which is just 1.0 miles away.

- Two bedrooms
- Two bathrooms
- Newly refurbished
- Split level
- Wooden flooring

#### Viewing

Please contact us on 020 7046 6276 if you wish to arrange a viewing appointment for this property or require further information.

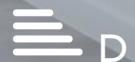

Floor Plan

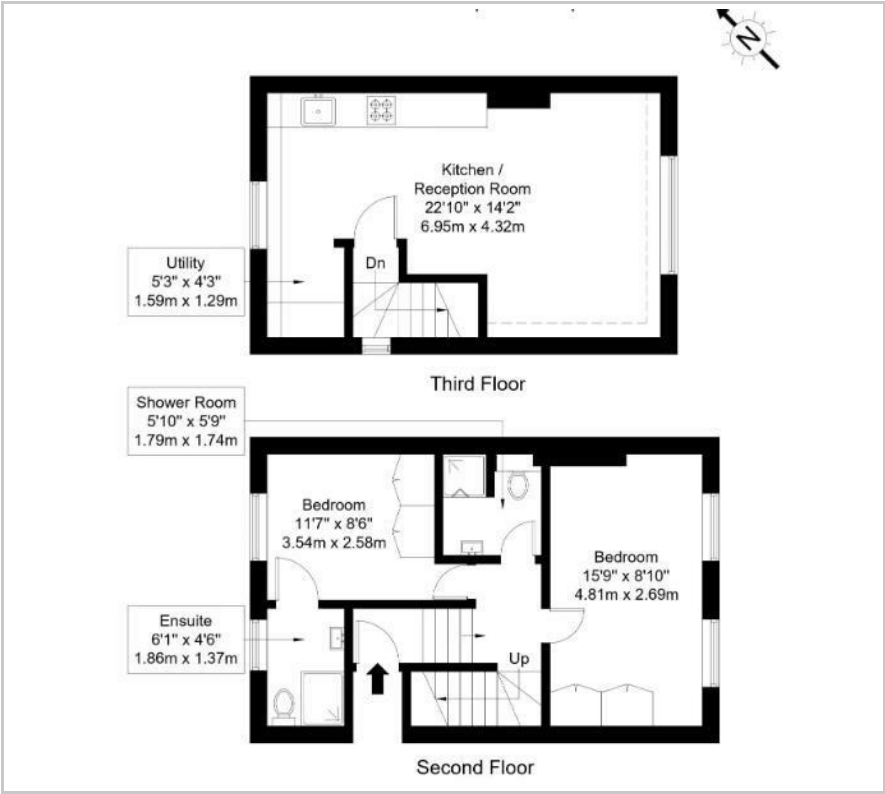

Area Map



Energy Efficiency Graph

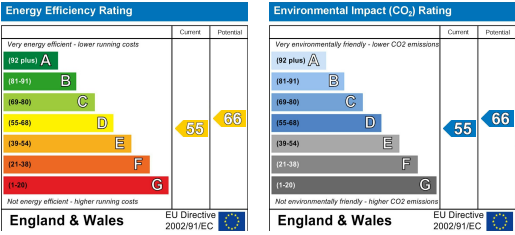

These particulars, whilst believed to be accurate are set out as a general outline only for guidance and do not constitute any part of an offer or contract. Intending purchasers should not rely on them as statements of representation of fact, but must satisfy themselves by inspection or otherwise as to their accuracy. No person in this firm's employment has the authority to make or give any representation or warranty in respect of the property.

020 7046 6276 • [lettings@charmillresidential.co.uk](mailto:lettings@charmillresidential.co.uk) • 51 Maida Vale, Little Venice, London W9 1SD  
[charmillresidential.co.uk](http://charmillresidential.co.uk)